



NATIONAL METAL SHAPES, INC.

425 S. SANDUSKY STREET

DELAWARE, OHIO 43015

(740) 363-9559

(800) 837-9559

FAX (740) 363-3000

TZ1416G

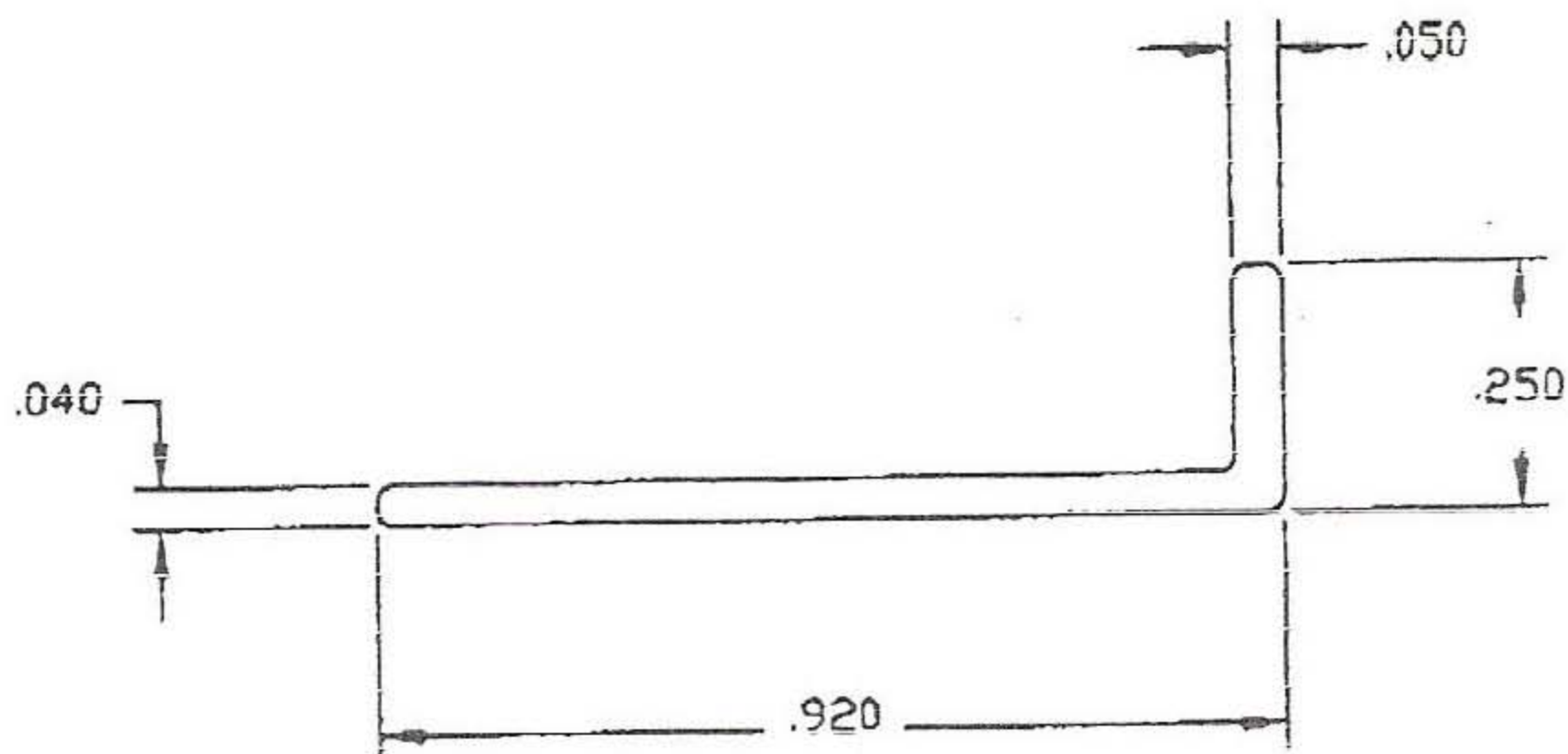

Item #: TZ1416G

Description: 1/4" High x 16 Ga. Wide (Top) x 6' Long, L-Angle Type Divider Strip. Can be Flexed (Notched) for Bending.

Material: Zinc

STANDARD TOLERANCES FOR EXTRUDED SHAPES APPLY UNLESS OTHERWISE SPECIFIED